

# NOFISOL

SOUND OF SILENCE



## NOFISOL®

### Installation Manuals v4.2



## Installation (short)

### NOFISOL® 21 dB as Sound Barrier

Measure the NOFISOL® 21 Barrier with a small excess, so that it can be fitted tightly between the constructions. The NOFISOL® 21 Barriers can be made to measure on site using, among other things, an insulation knife or saw with fine teeth. Before cutting/sawing to size, mark off the correct height and cut the aluminum foil on both sides of the bulkhead. Place the barrier in place and tilt it into its final position. Taping the seams with each other and with the surrounding building construction with NOFISOL® Alu tape is **NOT** necessary

### EXTRA processing when used as Smoke Barrier

Tape the NOFISOL® 21 Barriers on both sides (airtight) with NOFISOL® Alu Tape, this concerns the seams with each other and with the surrounding building construction, the connection with the bandraster does not need to be taped

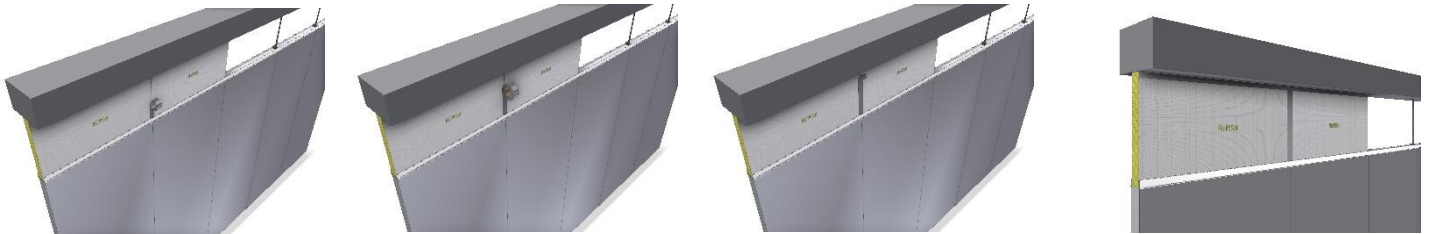

### EXTRA processing when used as Fire Barrier

Prior to the installation of the NOFISOL® 21 Barriers, place 2 strips of 12.5 mm plaster in the bandraster. Install the NOFISOL® 21 Barriers according to the installation instructions "Sound barrier". The seams between the barriers and the structural structure must also be provided with NOFISOL® fire-resistant adhesive. The NOFISOL® fire-resistant adhesive must be applied in dots every 10 cm in the seams with each other and with the surrounding building construction (not the bandraster) using a caulking gun. Taping the seams with each other and with the surrounding building construction with NOFISOL® Alu tape is **NOT** necessary.

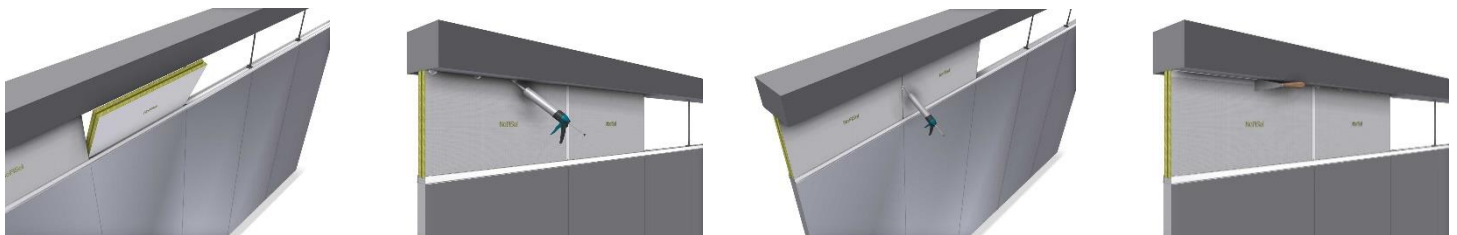

For detailed installation instructions, please refer to our website [www.nofisol.co.uk](http://www.nofisol.co.uk).

## Installation (short)

### NOFISOL® 22 dB as Sound Barrier

Measure the NOFISOL® 22 Barrier with a small excess, so that it can be fitted tightly between the constructions. The NOFISOL® 22 Barriers can be made to measure on site using, among other things, an insulation knife or saw with fine teeth. Before cutting/sawing to size, mark off the correct height and cut the aluminum foil on both sides of the bulkhead. Place the barrier in place and tilt it into its final position. Taping the seams together and onto the surrounding structure with NOFISOL® Alu tape is only on one side required

### EXTRA processing when used as Smoke Barrier

Tape the NOFISOL® 22 Barriers on both sides (airtight) with NOFISOL® Alu Tape, this concerns the seams with each other and with the surrounding building construction, the connection with the bandraster does not need to be taped

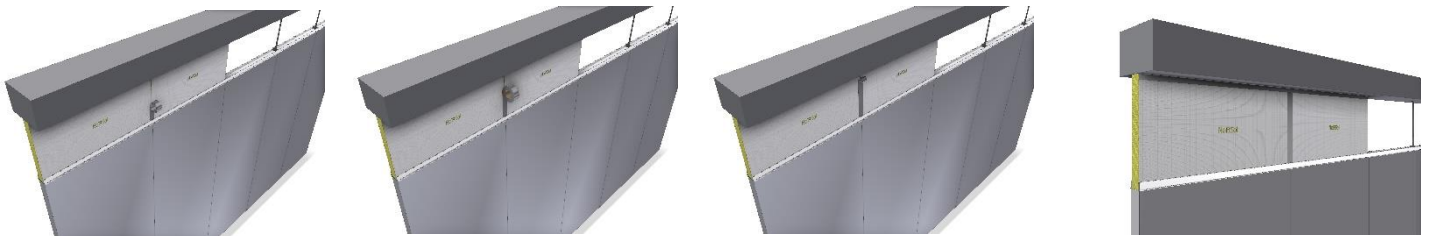

### EXTRA processing when used as Fire Barrier

Prior to the installation of the NOFISOL® 22 Barriers, place 2 strips of 12.5 mm plaster in the bandraster. Install the NOFISOL® 22 Barriers according to the installation instructions "Sound barrier". The seams between the barriers and the structural structure must also be provided with NOFISOL® fire-resistant adhesive. The NOFISOL® fire-resistant adhesive must be applied in dots every 10 cm in the seams with each other and with the surrounding building construction (not the bandraster) using a caulking gun. Taping the seams with each other and with the surrounding building construction with NOFISOL® Alu tape is NOT necessary.



For detailed installation instructions, please refer to our website [www.nofisol.co.uk](http://www.nofisol.co.uk).

## Installation (short)

### NOFISOL® 31 dB as Sound Barrier

Measure the NOFISOL® 31 Barrier with a small excess, so that it can be fitted tightly between the constructions. The NOFISOL® 31 Barriers can be made to measure on site using, among other things, an insulation knife or saw with fine teeth. Before cutting/sawing to size, mark off the correct height and cut the aluminum foil on both sides of the bulkhead. Place the barrier in place and tilt it into its final position. Taping the seams with each other and with the surrounding building construction with NOFISOL® Alu tape is **NOT** necessary

### EXTRA processing when used as Smoke Barrier

Tape the NOFISOL® 31 Barriers on both sides (airtight) with NOFISOL® Alu Tape, this concerns the seams with each other and with the surrounding building construction, the connection with the bandraster does not need to be taped

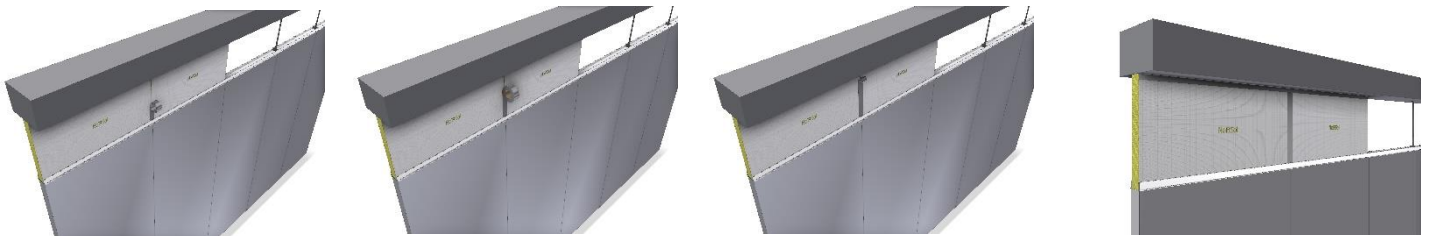

### EXTRA processing when used as Fire Barrier

Prior to the installation of the NOFISOL® 31 Barriers, place 2 strips of 12.5 mm plaster in the bandraster. Install the NOFISOL® 31 Barriers according to the installation instructions "Sound barrier". The seams between the barriers and the structural structure must also be provided with NOFISOL® fire-resistant adhesive. The NOFISOL® fire-resistant adhesive must be applied in dots every 10 cm in the seams with each other and with the surrounding building construction (not the bandraster) using a caulking gun. Taping the seams with each other and with the surrounding building construction with NOFISOL® Alu tape is **NOT** necessary.

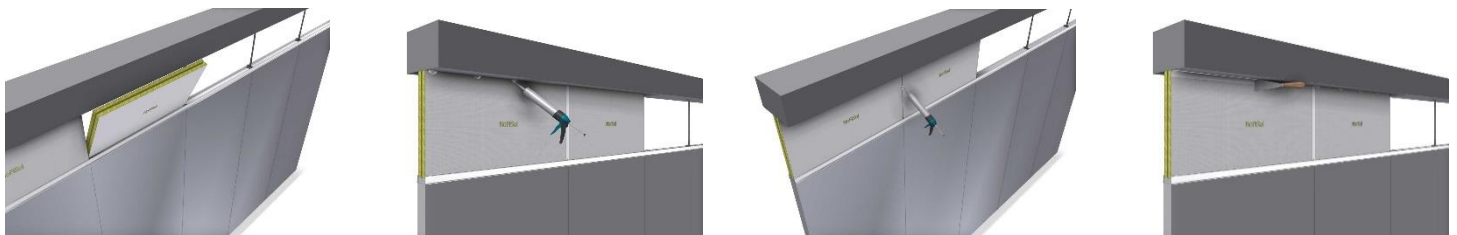

For detailed installation instructions, please refer to our website [www.nofisol.co.uk](http://www.nofisol.co.uk).

## Installation (short)

### NOFISOL® 33-LP dB as Sound Barrier

Measure the NOFISOL® 33-LP Barrier with a small excess, so that it can be fitted tightly between the constructions. The NOFISOL® 33-LP Barriers can be made to measure on site using, among other things, an insulation knife or saw with fine teeth. Before cutting/sawing to size, mark off the correct height and cut the aluminum foil on both sides of the bulkhead. Place the barrier in place and tilt it into its final position. Taping the seams with each other and with the surrounding building construction with NOFISOL® Alu tape is **NOT** necessary

### EXTRA processing when used as Smoke Barrier

Tape the NOFISOL® 33-LP Barriers on both sides (airtight) with NOFISOL® Alu Tape, this concerns the seams with each other and with the surrounding building construction, the connection with the bandraaster does not need to be taped

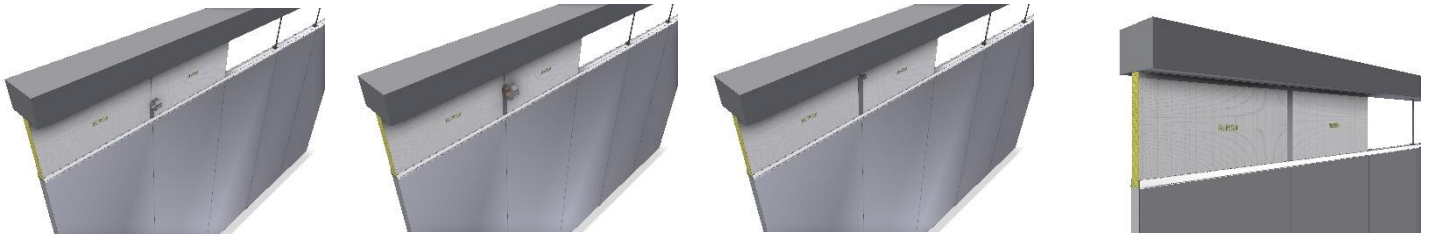

### EXTRA processing when used as Fire Barrier

Prior to the installation of the NOFISOL® 33-LP Barriers, place 2 strips of 12.5 mm plaster in the bandraaster. Install the NOFISOL® 33-LP Barriers according to the installation instructions "Sound barrier". The seams between the barriers and the structural structure must also be provided with NOFISOL® fire-resistant adhesive. The NOFISOL® fire-resistant adhesive must be applied in dots every 10 cm in the seams with each other and with the surrounding building construction (not the bandraaster) using a caulking gun. Taping the seams with each other and with the surrounding building construction with NOFISOL® Alu tape is **NOT** necessary.



For detailed installation instructions, please refer to our website [www.nofisol.co.uk](http://www.nofisol.co.uk).

## Installation (short)

### NOFISOL® 33 dB as Sound Barrier

Measure the NOFISOL® 33 Barrier with a small excess, so that it can be fitted tightly between the constructions. The NOFISOL® 33 Barriers can be made to measure on site using, among other things, an insulation knife or saw with fine teeth. Before cutting/sawing to size, mark off the correct height and cut the aluminum foil on both sides of the bulkhead. Place the barrier in place and tilt it into its final position. Taping the seams with each other and with the surrounding building construction with NOFISOL® Alu tape is **NOT** necessary

### EXTRA processing when used as Smoke Barrier

Tape the NOFISOL® 33 Barriers on both sides (airtight) with NOFISOL® Alu Tape, this concerns the seams with each other and with the surrounding building construction, the connection with the bandraster does not need to be taped

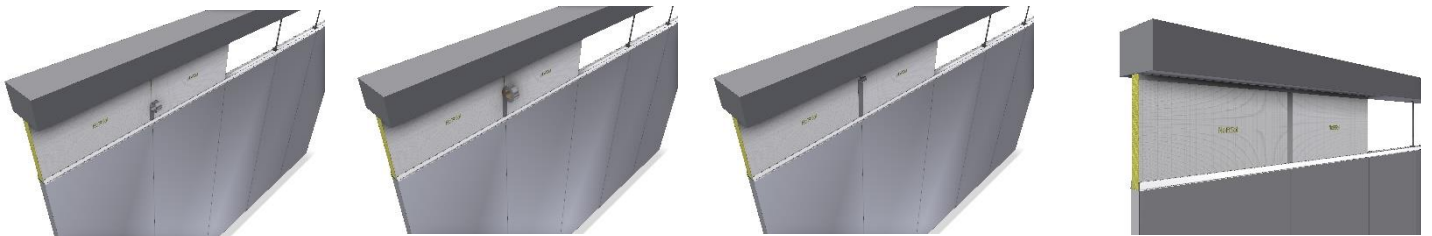

### EXTRA processing when used as Fire Barrier

Prior to the installation of the NOFISOL® 33 Barriers, place 2 strips of 12.5 mm plaster in the bandraster. Install the NOFISOL® 33 Barriers according to the installation instructions "Sound barrier". The seams between the barriers and the structural structure must also be provided with NOFISOL® fire-resistant adhesive. The NOFISOL® fire-resistant adhesive must be applied in dots every 10 cm in the seams with each other and with the surrounding building construction (not the bandraster) using a caulking gun. Taping the seams with each other and with the surrounding building construction with NOFISOL® Alu tape is **NOT** necessary.



For detailed installation instructions, please refer to our website [www.nofisol.com](http://www.nofisol.com)

## Installation (short version)

### NOFISOL® 38 High Value dB as Sound barrier

Measure the NOFISOL® 38 High Value dB basic element with a small excess, so that it can be fitted tightly between the constructions. The base elements can be made to measure on site using, among other things, an insulation knife or saw with fine teeth. Before cutting/sawing to size, mark off the correct height and cut the aluminum foil on both sides of the Barrier. Place the base element in place and tilt it into its final position. Then apply the self-adhesive NOFISOL® EP 4.5 Alu foil to one side of the base element as follows::

- Measure the height from the top of the bandraaster to the building structure and transfer these dimensions to the NOFISOL® EP 4.5 Alu Foil;
- Cut the NOFISOL® EP 4.5 Alu foil to the correct height and, if necessary, divide the length into 2 or 3 parts for convenience (not mandatory) to facilitate the application of the NOFISOL® EP 4.5 Alu foil;
- Remove the protective cover from the NOFISOL® EP 4.5 Alu foil at an angle over a length of approx. 3-5 cm;
- Position the NOFISOL® EP 4.5 Alu foil in the right place and press it firmly onto the base element;
- Carefully remove the protective cover and at the same time press the NOFISOL® EP 4.5 Alu Foil onto the base element in such a way that no “air bubbles” can form under the NOFISOL® EP 4.5 Alu Foil;
- If fastening elements protrude from the base element, the NOFISOL® EP 4.5 Alu Foil must be cut in those places so that they also protrude through the NOFISOL® EP 4.5 Alu Foil without causing “air bubbles”;
- The next piece of NOFISOL® EP 4.5 Alu Foil is applied next to the previously mounted element in such a way that they fit tightly without overlapping.

The NOFISOL® EP 4.5 Alu foil can easily be cut to size or processed for penetrations and openings. Taping the seams with each other and with the surrounding building construction with NOFISOL® Alu tape is NOT necessary.

### EXTRA processing when used as smoke barrier

Tape the basic elements on both sides (airtight) with NOFISOL® Alu Tape, this concerns the seams with each other and with the surrounding building construction, the connection with the bandraaster does not need to be taped. Then apply the EP 4.5 Alu foil.

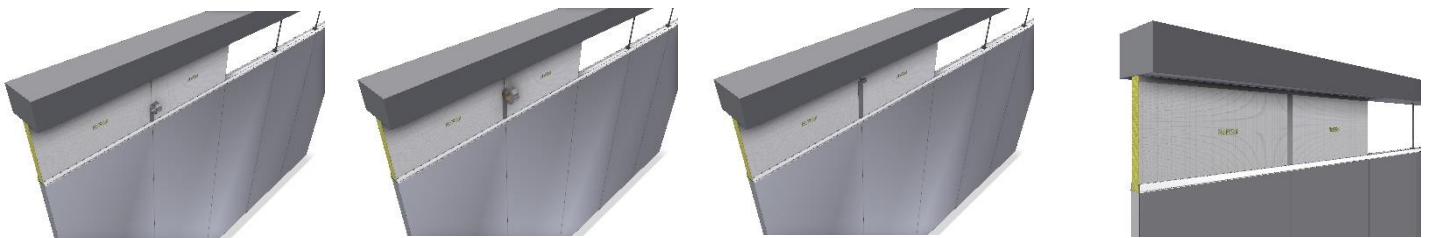

### EXTRA processing when used as Fire Barrier

Prior to the installation of the NOFISOL® Barriers, place 2 strips of 12.5 mm plaster in the bandraaster. Install the NOFISOL® Barriers according to the installation instructions “Sound barrier”. Then, before applying the NOFISOL® EP 4.5 Alu foil, the seams between the basic elements and the structural structure must be provided with NOFISOL® fire-resistant adhesive. The NOFISOL® fire-resistant adhesive must be applied in dots every 10 cm in the seams with each other and with the surrounding building construction (not the bandraaster) using a caulking gun. Taping the seams with NOFISOL® Alu Tape is NOT necessary.

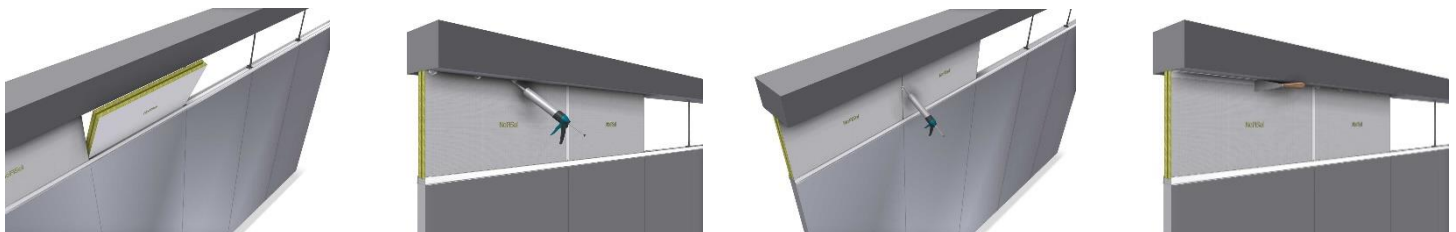

For detailed installation instructions, please refer to our website [www.nofisol.com](http://www.nofisol.com).

*This product sheet has been compiled based on both the current state of technology and current legislation and regulations. Since both legislation and regulations as well as the state of the art are subject to changes, this product sheet is also subject to changes. It is therefore recommended that you always check whether you are in possession of the latest current edition of this product sheet. For details regarding the correct area of application, associated restrictions, boundaries and connections, we refer, among other things, to the Expert Judgments drawn up by Peutz BV, or we request that you contact us. No rights or obligations can be derived from this product sheet*

**Nofisol Europe BV**  
Everdenberg 9-d  
4902 TT Oosterhout

Postbus 4042  
4900 CA Oosterhout

+31 (0)162 431 231  
[europe@nofisol.com](mailto:europe@nofisol.com)  
[www.nofisol.com](http://www.nofisol.com)

KvK : 20124896  
BTW nr : NL8156.99.761.B01  
IBAN : NL46 RABO 0106 2819 33

## Installatio (short version)

### NOFISOL® 39 High Value dB as Sound barrier

Measure the NOFISOL® 39 High Value dB basic element with a small excess, so that it can be fitted tightly between the constructions. The base elements can be made to measure on site using, among other things, an insulation knife or saw with fine teeth. Before cutting/sawing to size, mark off the correct height and cut the aluminum foil on both sides of the Barrier. Place the base element in place and tilt it into its final position. Then apply the self-adhesive NOFISOL® EP 8 Alu foil to one side of the base element as follows::

- Measure the height from the top of the bandraaster to the building structure and transfer these dimensions to the NOFISOL® EP 8 Alu Foil;
- Cut the NOFISOL® EP 8 Alu foil to the correct height and, if necessary, divide the length into 2 or 3 parts for convenience (not mandatory) to facilitate the application of the NOFISOL® EP 8 Alu foil;
- Remove the protective cover from the NOFISOL® EP 8 Alu foil at an angle over a length of approx. 3-5 cm;
- Position the NOFISOL® EP 8 Alu foil in the right place and press it firmly onto the base element;
- Carefully remove the protective cover and at the same time press the NOFISOL® EP 8 Alu Foil onto the base element in such a way that no “air bubbles” can form under the NOFISOL® EP 8 Alu Foil;
- If fastening elements protrude from the base element, the NOFISOL® EP 8 Alu Foil must be cut in those places so that they also protrude through the NOFISOL® EP 8 Alu Foil without causing “air bubbles”;
- The next piece of NOFISOL® EP 8 Alu Foil is applied next to the previously mounted element in such a way that they fit tightly without overlapping.

The NOFISOL® EP 8 Alu foil can easily be cut to size or processed for penetrations and openings. Taping the seams with each other and with the surrounding building construction with NOFISOL® Alu tape is NOT necessary.

### EXTRA processing when used as smoke barrier

Tape the basic elements on both sides (airtight) with NOFISOL® Alu Tape, this concerns the seams with each other and with the surrounding building construction, the connection with the bandraaster does not need to be taped. Then apply the EP 8 Alu foil.

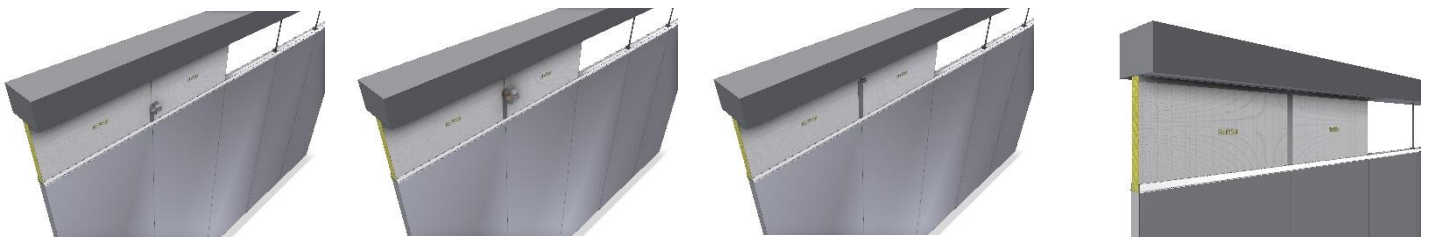

### EXTRA processing when used as Fire Barrier

Prior to the installation of the NOFISOL® Barriers, place 2 strips of 12.5 mm plaster in the bandraaster. Install the NOFISOL® Barriers according to the installation instructions “Sound barrier”. Then, before applying the NOFISOL® EP 8 Alu foil, the seams between the basic elements and the structural structure must be provided with NOFISOL® fire-resistant adhesive. The NOFISOL® fire-resistant adhesive must be applied in dots every 10 cm in the seams with each other and with the surrounding building construction (not the bandraaster) using a caulking gun. Taping the seams with NOFISOL® Alu Tape is NOT necessary.

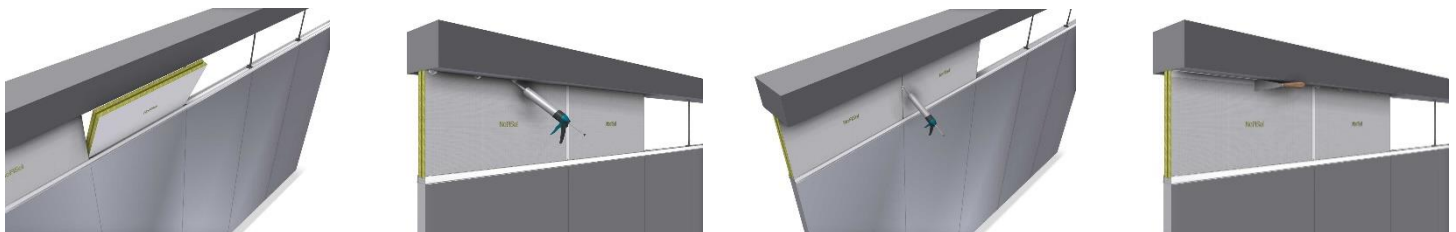

For detailed installation instructions, please refer to our website [www.nofisol.com](http://www.nofisol.com).

*This product sheet has been compiled based on both the current state of technology and current legislation and regulations. Since both legislation and regulations as well as the state of the art are subject to changes, this product sheet is also subject to changes. It is therefore recommended that you always check whether you are in possession of the latest current edition of this product sheet. For details regarding the correct area of application, associated restrictions, boundaries and connections, we refer, among other things, to the Expert Judgments drawn up by Peutz BV, or we request that you contact us. No rights or obligations can be derived from this product sheet*

**Nofisol Europe BV**  
Everdenberg 9-d  
4902 TT Oosterhout

Postbus 4042  
4900 CA Oosterhout

+31 (0)162 431 231  
[europe@nofisol.com](mailto:europe@nofisol.com)  
[www.nofisol.com](http://www.nofisol.com)

KvK : 20124896  
BTW nr : NL8156.99.761.B01  
IBAN : NL46 RABO 0106 2819 33



## Installation (short version)

### NOFISOL® 40 High Value dB as Sound barrier

Measure the NOFISOL® 40 High Value dB basic element with a small excess, so that it can be fitted tightly between the constructions. The base elements can be made to measure on site using, among other things, an insulation knife or saw with fine teeth. Before cutting/sawing to size, mark off the correct height and cut the aluminum foil on both sides of the Barrier. Place the base element in place and tilt it into its final position. Then apply the self-adhesive NOFISOL® EP 4.5 Alu foil to both sides of the base element as follows::

- Measure the height from the top of the bandraaster to the building structure and transfer these dimensions to the NOFISOL® EP 4.5 Alu Foil;
- Cut the NOFISOL® EP 4.5 Alu foil to the correct height and, if necessary, divide the length into 2 or 3 parts for convenience (not mandatory) to facilitate the application of the NOFISOL® EP 4.5 Alu foil;
- Remove the protective cover from the NOFISOL® EP 4.5 Alu foil at an angle over a length of approx. 3-5 cm;
- Position the NOFISOL® EP 4.5 Alu foil in the right place and press it firmly onto the base element;
- Carefully remove the protective cover and at the same time press the NOFISOL® EP 4.5 Alu Foil onto the base element in such a way that no “air bubbles” can form under the NOFISOL® EP 4.5 Alu Foil;
- If fastening elements protrude from the base element, the NOFISOL® EP 4.5 Alu Foil must be cut in those places so that they also protrude through the NOFISOL® EP 4.5 Alu Foil without causing “air bubbles”;
- The next piece of NOFISOL® EP 4.5 Alu Foil is applied next to the previously mounted element in such a way that they fit tightly without overlapping.

The NOFISOL® EP 4.5 Alu foil can easily be cut to size or processed for penetrations and openings. Taping the seams with each other and with the surrounding building construction with NOFISOL® Alu tape is NOT necessary.

### EXTRA processing when used as smoke barrier

Tape the basic elements on both sides (airtight) with NOFISOL® Alu Tape, this concerns the seams with each other and with the surrounding building construction, the connection with the bandraaster does not need to be taped. Then apply the EP 4.5 Alu foil.

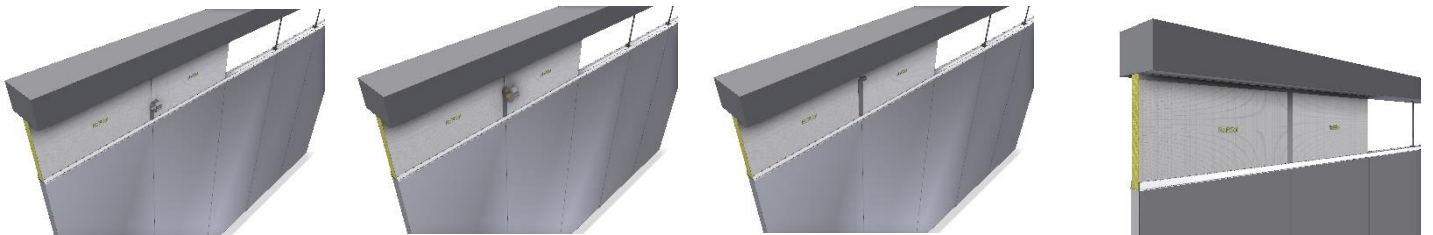

### EXTRA processing when used as Fire Barrier

Prior to the installation of the NOFISOL® Barriers, place 2 strips of 12.5 mm plaster in the bandraaster. Install the NOFISOL® Barriers according to the installation instructions “Sound barrier”. Then, before applying the NOFISOL® EP 4.5 Alu foil, the seams between the basic elements and the structural structure must be provided with NOFISOL® fire-resistant adhesive. The NOFISOL® fire-resistant adhesive must be applied in dots every 10 cm in the seams with each other and with the surrounding building construction (not the bandraaster) using a caulking gun. Taping the seams with NOFISOL® Alu Tape is NOT necessary.

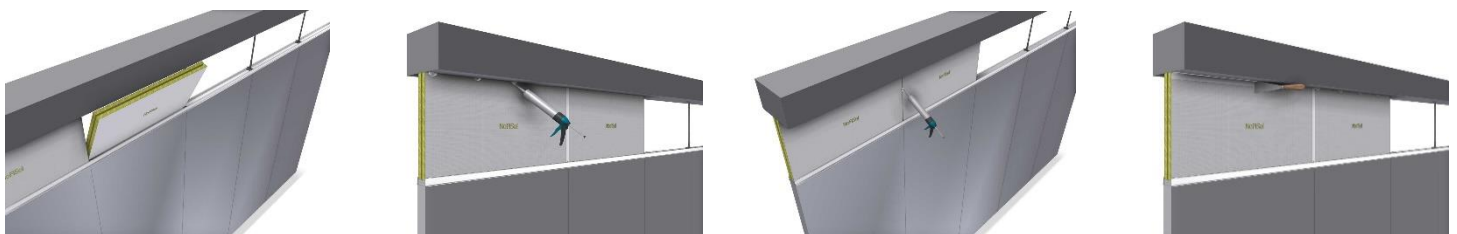

For detailed installation instructions, please refer to our website [www.nofisol.com](http://www.nofisol.com).

*This product sheet has been compiled based on both the current state of technology and current legislation and regulations. Since both legislation and regulations as well as the state of the art are subject to changes, this product sheet is also subject to changes. It is therefore recommended that you always check whether you are in possession of the latest current edition of this product sheet. For details regarding the correct area of application, associated restrictions, boundaries and connections, we refer, among other things, to the Expert Judgments drawn up by Peutz BV, or we request that you contact us. No rights or obligations can be derived from this product sheet*

**Nofisol Europe BV**  
Everdenberg 9-d  
4902 TT Oosterhout

Postbus 4042  
4900 CA Oosterhout

+31 (0)162 431 231  
europe@nofisol.com  
www.nofisol.com

KvK : 20124896  
BTW nr : NL8156.99.761.B01  
IBAN : NL46 RABO 0106 2819 33

## Installation (short version)

### NOFISOL® 45 High Value dB as Sound barrier

Measure the NOFISOL® 45 High Value dB basic element with a small excess, so that it can be fitted tightly between the constructions. The base elements can be made to measure on site using, among other things, an insulation knife or saw with fine teeth. Before cutting/sawing to size, mark off the correct height and cut the aluminum foil on both sides of the Barrier. Place the base element in place and tilt it into its final position. Then apply the self-adhesive NOFISOL® EP 8 Alu foil to both sides of the base element as follows::

- Measure the height from the top of the bandraaster to the building structure and transfer these dimensions to the NOFISOL® EP 8 Alu Foil;
- Cut the NOFISOL® EP 8 Alu foil to the correct height and, if necessary, divide the length into 2 or 3 parts for convenience (not mandatory) to facilitate the application of the NOFISOL® EP 8 Alu foil;
- Remove the protective cover from the NOFISOL® EP 8 Alu foil at an angle over a length of approx. 3-5 cm;
- Position the NOFISOL® EP 8 Alu foil in the right place and press it firmly onto the base element;
- Carefully remove the protective cover and at the same time press the NOFISOL® EP 8 Alu Foil onto the base element in such a way that no “air bubbles” can form under the NOFISOL® EP 8 Alu Foil;
- If fastening elements protrude from the base element, the NOFISOL® EP 8 Alu Foil must be cut in those places so that they also protrude through the NOFISOL® EP 8 Alu Foil without causing “air bubbles”;
- The next piece of NOFISOL® EP 8 Alu Foil is applied next to the previously mounted element in such a way that they fit tightly without overlapping.

The NOFISOL® EP 8 Alu foil can easily be cut to size or processed for penetrations and openings. Taping the seams with each other and with the surrounding building construction with NOFISOL® Alu tape is NOT necessary.

### EXTRA processing when used as smoke barrier

Tape the basic elements on both sides (airtight) with NOFISOL® Alu Tape, this concerns the seams with each other and with the surrounding building construction, the connection with the bandraaster does not need to be taped. Then apply the EP 8 Alu foil.

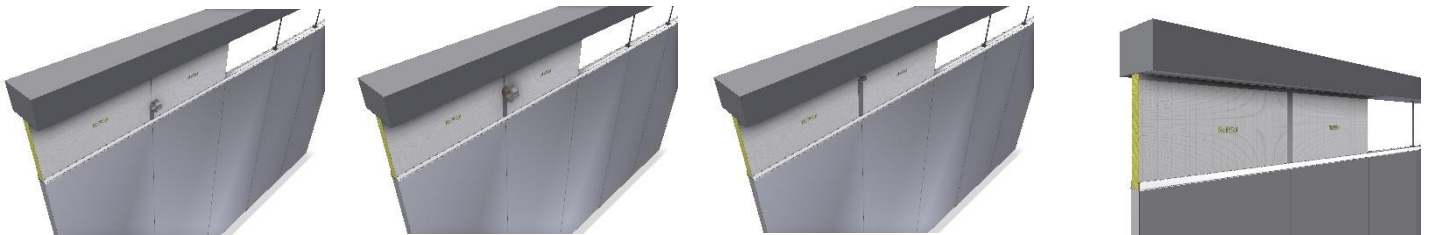

### EXTRA processing when used as Fire Barrier

Prior to the installation of the NOFISOL® Barriers, place 2 strips of 12.5 mm plaster in the bandraaster. Install the NOFISOL® Barriers according to the installation instructions “Sound barrier”. Then, before applying the NOFISOL® EP 8 Alu foil, the seams between the basic elements and the structural structure must be provided with NOFISOL® fire-resistant adhesive. The NOFISOL® fire-resistant adhesive must be applied in dots every 10 cm in the seams with each other and with the surrounding building construction (not the bandraaster) using a caulking gun. Taping the seams with NOFISOL® Alu Tape is NOT necessary.

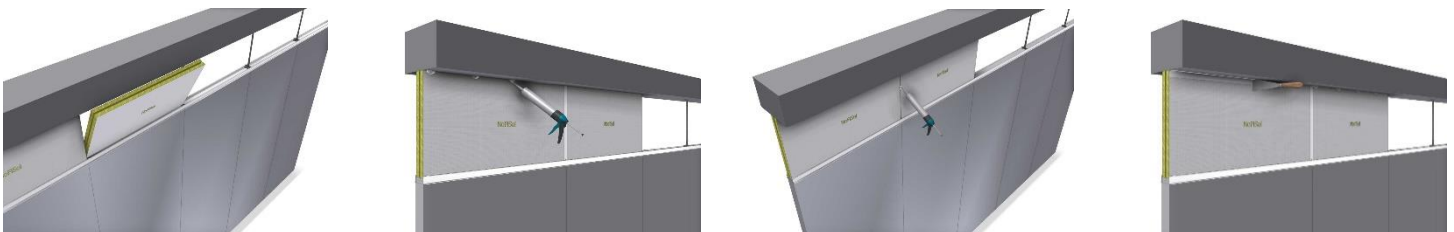

For detailed installation instructions, please refer to our website [www.nofisol.com](http://www.nofisol.com).

*This product sheet has been compiled based on both the current state of technology and current legislation and regulations. Since both legislation and regulations as well as the state of the art are subject to changes, this product sheet is also subject to changes. It is therefore recommended that you always check whether you are in possession of the latest current edition of this product sheet. For details regarding the correct area of application, associated restrictions, boundaries and connections, we refer, among other things, to the Expert Judgments drawn up by Peutz BV, or we request that you contact us. No rights or obligations can be derived from this product sheet*

**Nofisol Europe BV**  
Everdenberg 9-d  
4902 TT Oosterhout

Postbus 4042  
4900 CA Oosterhout

+31 (0)162 431 231  
[europe@nofisol.com](mailto:europe@nofisol.com)  
[www.nofisol.com](http://www.nofisol.com)

KvK : 20124896  
BTW nr : NL8156.99.761.B01  
IBAN : NL46 RABO 0106 2819 33

## Installation (short version)

### NOFISOL® eXtreme 40-H as Sound barrier

Measure the NOFISOL® eXtreme 40-H basic element with a small excess, so that it can be fitted tightly between the constructions. The base elements can be made to measure on site using, among other things, an insulation knife or saw with fine teeth. Before cutting/sawing to size, mark off the correct height and cut the aluminum foil on both sides of the Barrier. Place the base element in place and tilt it into its final position. Then apply the self-adhesive NOFISOL® EP E Alu foil to one side of the base element as follows:

- Measure the height from the top of the bandraaster to the building structure and transfer these dimensions to the NOFISOL® EP E Alu Foil;
- Cut the NOFISOL® EP E Alu foil to the correct height and, if necessary, divide the length into 2 or 3 parts for convenience (not mandatory) to facilitate the application of the NOFISOL® EP E Alu foil;
- Remove the protective cover from the NOFISOL® EP E Alu foil at an angle over a length of approx. 3-5 cm;
- Position the NOFISOL® EP E Alu foil in the right place and press it firmly onto the base element;
- Carefully remove the protective cover and at the same time press the NOFISOL® EP E Alu Foil onto the base element in such a way that no “air bubbles” can form under the NOFISOL® EP E Alu Foil;
- If fastening elements protrude from the base element, the NOFISOL® EP E Alu Foil must be cut in those places so that they also protrude through the NOFISOL® EP E Alu Foil without causing “air bubbles”;
- The next piece of NOFISOL® EP E Alu Foil is applied next to the previously mounted element in such a way that they fit tightly without overlapping.

The NOFISOL® EP E Alu foil can easily be cut to size or processed for penetrations and openings. Taping the seams with each other and with the surrounding building construction with NOFISOL® Alu tape is NOT necessary.

### EXTRA processing when used as smoke barrier

Tape the basic elements on both sides (airtight) with NOFISOL® Alu Tape, this concerns the seams with each other and with the surrounding building construction, the connection with the bandraaster does not need to be taped. Then apply the EP E Alu foil.

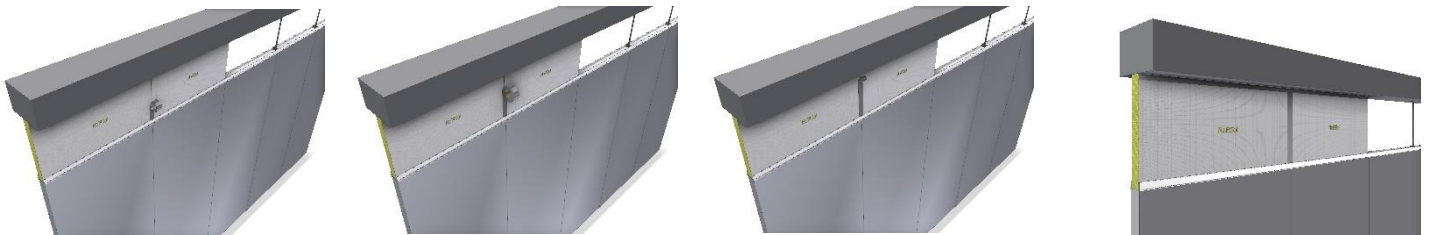

### EXTRA processing when used as Fire Barrier

Prior to the installation of the NOFISOL®, place 2 strips of 12.5 mm plaster in the bandraaster. Install the NOFISOL® Barriers according to the installation instructions “Sound barrier”. Then, before applying the NOFISOL® EP E Alu foil, the seams between the basic elements and the structural structure must be provided with NOFISOL® fire-resistant adhesive. The NOFISOL® fire-resistant adhesive must be applied in dots every 10 cm in the seams with each other and with the surrounding building construction (not the bandraaster) using a caulking gun. Taping the seams with NOFISOL® Alu Tape is NOT necessary.

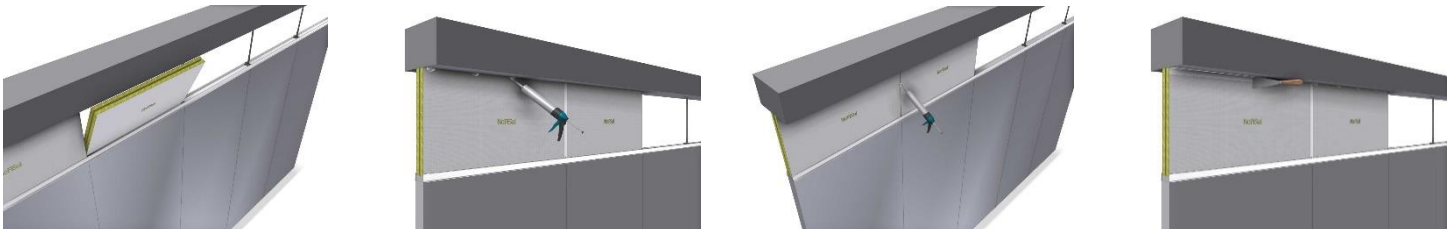

For detailed installation instructions, please refer to our website [www.nofisol.com](http://www.nofisol.com).

*This product sheet has been compiled based on both the current state of technology and current legislation and regulations. Since both legislation and regulations as well as the state of the art are subject to changes, this product sheet is also subject to changes. It is therefore recommended that you always check whether you are in possession of the latest current edition of this product sheet. For details regarding the correct area of application, associated restrictions, boundaries and connections, we refer, among other things, to the Expert Judgments drawn up by Peutz BV, or we request that you contact us. No rights or obligations can be derived from this product sheet*

**Nofisol Europe BV**  
Everdenberg 9-d  
4902 TT Oosterhout

Postbus 4042  
4900 CA Oosterhout

+31 (0)162 431 231  
[europe@nofisol.com](mailto:europe@nofisol.com)  
[www.nofisol.com](http://www.nofisol.com)

KvK : 20124896  
BTW nr : NL8156.99.761.B01  
IBAN : NL46 RABO 0106 2819 33

## Installation (short version)

### NOFISOL® eXtreme 47 as Sound barrier

Measure the NOFISOL® eXtreme 47 basic element with a small excess, so that it can be fitted tightly between the constructions. The base elements can be made to measure on site using, among other things, an insulation knife or saw with fine teeth. Before cutting/sawing to size, mark off the correct height and cut the aluminum foil on both sides of the Barrier. Place the base element in place and tilt it into its final position. Then apply the self-adhesive NOFISOL® EP E Alu foil to both sides of the base element as follows:

- Measure the height from the top of the bandraaster to the building structure and transfer these dimensions to the NOFISOL® EP E Alu Foil;
- Cut the NOFISOL® EP E Alu foil to the correct height and, if necessary, divide the length into 2 or 3 parts for convenience (not mandatory) to facilitate the application of the NOFISOL® EP E Alu foil;
- Remove the protective cover from the NOFISOL® EP E Alu foil at an angle over a length of approx. 3-5 cm;
- Position the NOFISOL® EP E Alu foil in the right place and press it firmly onto the base element;
- Carefully remove the protective cover and at the same time press the NOFISOL® EP E Alu Foil onto the base element in such a way that no “air bubbles” can form under the NOFISOL® EP E Alu Foil;
- If fastening elements protrude from the base element, the NOFISOL® EP E Alu Foil must be cut in those places so that they also protrude through the NOFISOL® EP E Alu Foil without causing “air bubbles”;
- The next piece of NOFISOL® EP E Alu Foil is applied next to the previously mounted element in such a way that they fit tightly without overlapping.

The NOFISOL® EP E Alu foil can easily be cut to size or processed for penetrations and openings. Taping the seams with each other and with the surrounding building construction with NOFISOL® Alu tape is NOT necessary.

### EXTRA processing when used as smoke barrier

Tape the basic elements on both sides (airtight) with NOFISOL® Alu Tape, this concerns the seams with each other and with the surrounding building construction, the connection with the bandraaster does not need to be taped. Then apply the EP E Alu foil.

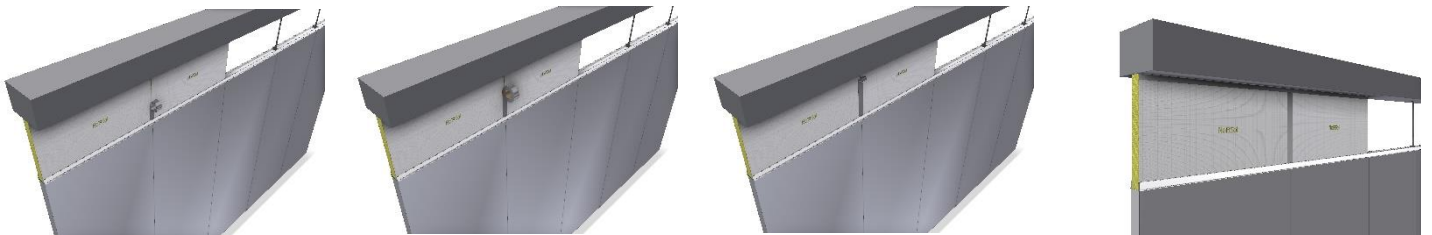

### EXTRA processing when used as Fire Barrier

Prior to the installation of the NOFISOL® Barriers, place 2 strips of 12.5 mm plaster in the bandraaster. Install the NOFISOL® Barriers according to the installation instructions “Sound barrier”. Then, before applying the NOFISOL® EP E Alu foil, the seams between the basic elements and the structural structure must be provided with NOFISOL® fire-resistant adhesive. The NOFISOL® fire-resistant adhesive must be applied in dots every 10 cm in the seams with each other and with the surrounding building construction (not the bandraaster) using a caulking gun. Taping the seams with NOFISOL® Alu Tape is NOT necessary.

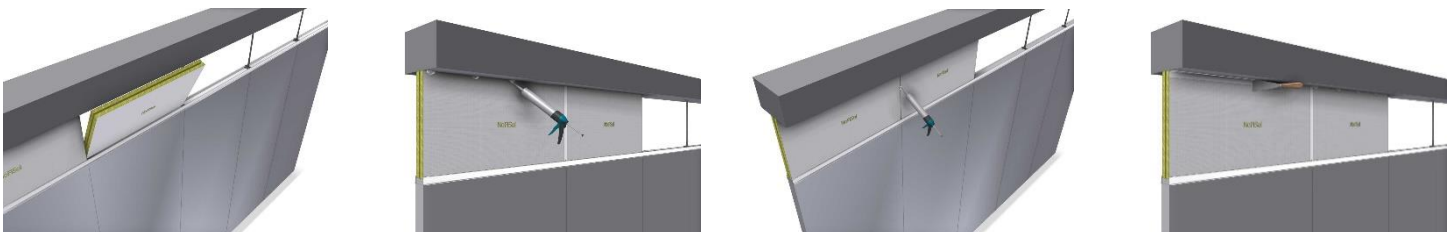

For detailed installation instructions, please refer to our website [www.nofisol.com](http://www.nofisol.com).

*This product sheet has been compiled based on both the current state of technology and current legislation and regulations. Since both legislation and regulations as well as the state of the art are subject to changes, this product sheet is also subject to changes. It is therefore recommended that you always check whether you are in possession of the latest current edition of this product sheet. For details regarding the correct area of application, associated restrictions, boundaries and connections, we refer, among other things, to the Expert Judgments drawn up by Peutz BV, or we request that you contact us. No rights or obligations can be derived from this product sheet*

**Nofisol Europe BV**  
Everdenberg 9-d  
4902 TT Oosterhout

Postbus 4042  
4900 CA Oosterhout

+31 (0)162 431 231  
[europe@nofisol.com](mailto:europe@nofisol.com)  
[www.nofisol.com](http://www.nofisol.com)

KvK : 20124896  
BTW nr : NL8156.99.761.B01  
IBAN : NL46 RABO 0106 2819 33



NoFISol

NoFISol

NoFISol

NoF

**Nofisol Europe BV**  
Everdenberg 9-d  
4902 TT Oosterhout

Postbus 4042  
4900 CA Oosterhout

+31 (0)162 431 231  
europe@nofisol.com  
www.nofisol.com

KvK : 20124896  
BTW nr : NL8156.99.761.B01  
IBAN : NL46 RABO 0106 2819 33